

GEBRAUCHSANLEITUNG

TWIST 140

Art.Nr. • Réf. • Part No. **30015**

The logo for JUWEL, featuring the word "JUWEL" in a bold, sans-serif font inside a rectangular border. A small registered trademark symbol (®) is located to the upper right of the word.

Austrian description (in English):

GB – TWIST 140

Please make sure to hang your laundry evenly.
Don't use during storms !

- A Airer front frame
- B Airer back frame
- C Airer supports
- D Buttons to collapse airer
- E Wall bracket with screws and dowels

1) To open pull legs from the catches (legs engage automatically).

2) Unfolding the frame: Slightly lift front frame profile to release it from the catch and pull forward. To collapse legs, press the red button.
ATTENTION: Do not use force. The frame must be easy to push in, otherwise the folding direction is wrong.

The “buttons” on each end will release the 4 legs. Just push on them and the legs will fold down and lock in place. When you

are ready to put the Twist up, push the buttons and the legs will fold back.

The Sides slide forward and back. You can use one side and not the other, if you choose, for drying your laundry. You can also hang your laundry from one side, and close the side slightly to more easily move the stand from one location to another (that is especially helpful when going through doorways).

Install the hanging bracket on the wall where you want to keep your Twist. Screw the bracket into the wall. The T-shaped bracket on the back of the Twist will easily slide into the wall mount so it can hang against the wall.

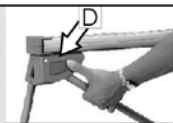
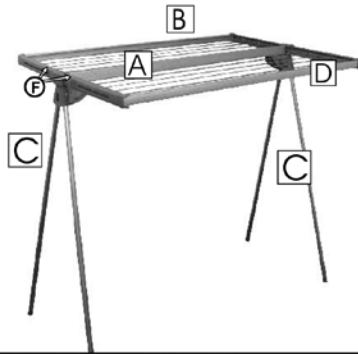

Art. Nr. 08101428
© 2008 JUWEL GmbH

A	vord. Trockenrahmen
B	hint. Trockenrahmen
C	Standbeine
D	Tasten zum Schließen
E	Wandhalter mit Dübel und Schrauben

Bitte beachten Sie nachfolgende Gebrauchshinweise, damit Ihnen Ihr Wäschetrockner TWIST 140 lange dienen kann. Bei Anregungen oder Vorschlägen schreiben Sie bitte an:
JUWEL H. Wäster GmbH, D-82467 Garmisch Partenkirchen, Bahnhofstraße 31 oder A-6460 Imst, Industriezone 19 kund@juwel.com • www.juwel.com

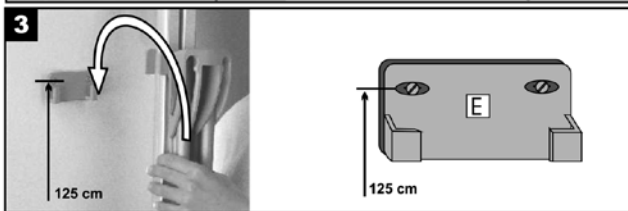
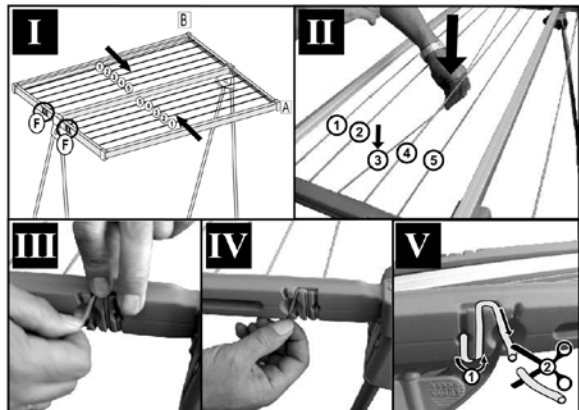
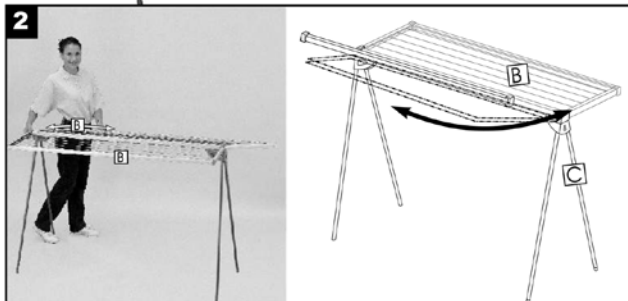

Anleitung • Instruction :

Nachspannen der Leine:

- I-II) Leine Reihe um Reihe von außen nach innen durch hinunter drücken der Leine (siehe Bild II) Nachspannen.
- III) Leine aus Fixierung (F) lösen und spannen.
- IV) In Fixierung (F) wieder eindringen.
- V) Entstandenen Überstand abschneiden.

Pour retendre la corde à linge :

- I-II) Retendre la corde rangée par rangée en y appuyant dessus (Voir schéma II).
- III) Enlever la corde du système de fixation (F) et retendre.
- IV) Coincer la corde dans le système de fixation (F).
- V) Couper le bout qui dépasse.

Tightening of clothes line:

- I-II) Tighten the clothes line row by row from outside to inside by pressing the line downwards (see sketch II).
- III) Loosen the line from his line clamp (F) & tighten it
- IV) Fix it again in the line clamp (F)
- V) Cut off the rest of the too long line.